

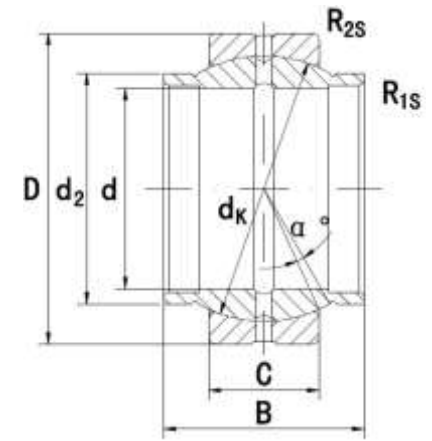

MICHIGAN MANUFACTURING
International



Radial Spherical Plain Bearings GE..LO

- Outer ring with single split in axial direction.
- inner ring with cylindrical extensions at both sides.
- Lubrication grooves and holes in the outer and inner rings.
- Both outer and inner rings are properly phosphate treated.

Part No.	Dimensions mm									Load ratings KN		weight kg
	d	d2	D	B	C	dk	R1s min	R2s min	α \approx	dyn. C	stat. C0	
GE12LO	12	15.5	22	12	7	18	0.3	0.3	4	10	54	0.022
GE16LO	16	20	28	16	9	23	0.3	0.3	4	17.6	88	0.035
GE20LO	20	25	35	20	12	29	0.3	0.3	4	30	146	0.070
GE25LO	25	30.5	42	25	16	35.5	0.6	0.6	4	48	240	0.120
GE30LO	30	34	47	30	18	40.7	0.6	0.6	4	62	310	0.168
GE32LO	32	37	52	32	18	44	0.6	1.0	4	67	335	0.200
GE35LO	35	40	55	35	20	47	0.6	1.0	4	79	399	0.253
GE40LO	40	46	62	40	22	53	0.6	1.0	4	100	500	0.340
GE45LO	45	52	68	45	25	60	0.6	1	4	127	637	0.481
GE50LO	50	57	75	50	28	66	0.6	1.0	4	156	780	0.560
GE60LO	60	68	90	60	36	80	1.0	1.0	4	245	1220	1.15
GE63LO	63	71.5	95	63	36	83	1.0	1.0	4	255	1270	1.20
GE70LO	70	78	105	70	40	92	1.0	1.0	4	315	1560	1.70
GE80LO	80	91	120	80	45	105	1.0	1.0	4	400	2000	2.40
GE90LO	90	99	130	90	50	115	1.0	1.0	4	488	2440	3.20
GE100LO	100	113	150	100	55	130	1.0	1.0	4	607	3030	4.80
GE110LO	110	124	160	110	55	140	1.0	1.0	4	654	3270	5.78
GE125LO	125	138	180	125	70	160	1.0	1.0	4	950	4750	8.49
GE160LO	160	177	230	160	80	200	1.0	1.0	4	1360	6800	16.5
GE200LO	200	221	290	200	100	250	1.1	1.1	4	2120	10600	32.1
GE250LO	250	317	400	250	120	350	1.1	1.1	4	3750	17800	99.1
GE320LO	320	405	520	320	160	450	1.1	1.1	4	6200	30500	225