

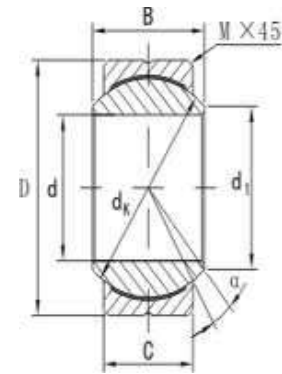

**MICHIGAN MANUFACTURING**  
International



### Radial Spherical plain Bearings COM..T/HCOM..T

- Outer ring pressed around inner ring.
- outer race lined with PTFE fabric.
- In inch dimension Series.

Part No.	Dimensions mm								load ratingsKN	weight kg
	d	d1	B	C	D	dk	m	$\alpha$ ≈		
COM3T	4.826	7.44	7.14	5.54	14.29	10.31	0.381	11	21.68	0.006
COM4T	6.350	9.25	8.71	6.35	16.67	12.70	0.560	13.5	33.02	0.010
COM5T	7.938	10.64	9.53	7.14	19.05	14.27	0.810	12	43.20	0.014
COM6T	9.525	13.11	10.31	7.92	20.64	16.66	0.810	10	56.04	0.017
COM7T	11.113	13.46	11.10	8.71	23.02	17.45	0.810	8.0	63.07	0.021
COM8T	12.700	16.26	12.70	9.91	25.40	20.65	0.810	9.5	88.39	0.029
COM9T	14.288	18.03	14.27	11.10	27.78	23.01	0.810	9.5	110.94	0.039
COM10T	15.875	19.81	15.88	12.70	30.16	25.40	0.810	8.5	141.96	0.050
COM12T	19.050	23.37	19.05	15.06	36.51	30.15	1.120	9.0	212.94	0.093
COM14T	22.225	24.89	22.23	17.86	39.69	33.32	1.120	9.5	279.93	0.119
COM16T	25.400	28.40	25.40	20.24	44.45	38.10	1.120	10	368.25	0.175
HCOM16T	25.400	34.54	25.40	19.84	50.80	42.85	0.810	9.0	472.46	0.251
HCOM19T	30.163	40.89	30.15	23.80	60.33	50.80	0.810	8.5	672.00	0.406
HCOM20T	31.750	40.89	30.15	23.80	60.33	50.80	0.810	8.5	672.00	0.406
HCOM24T	38.100	47.24	34.93	27.79	69.85	58.72	0.810	8.5	906.96	0.616
HCOM28T	44.450	53.59	39.67	31.75	79.38	66.68	1.120	8.0	1176.61	0.884
HCOM32T	50.800	59.94	44.45	34.93	88.90	74.60	1.120	8.5	1448.06	1.198